

40 Smith & Wesson

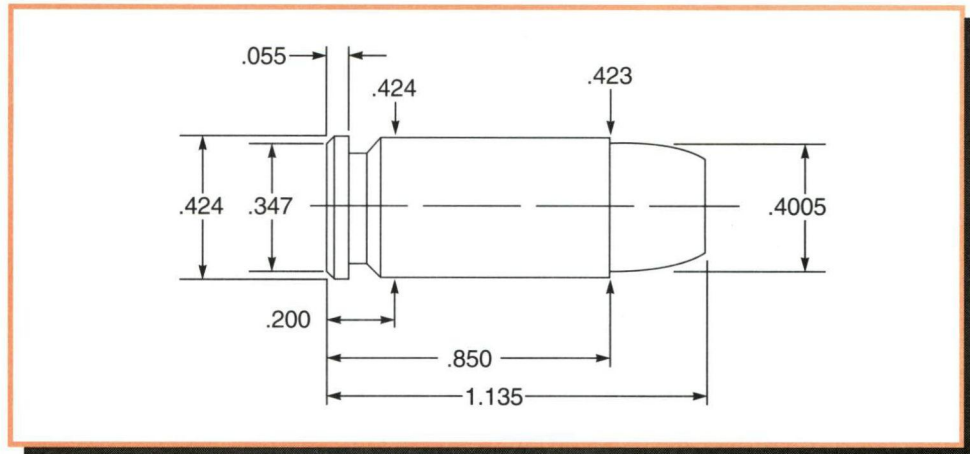

Comments:

The 40 S&W has quickly become a very popular cartridge as it is a good choice between the 9mm and 45 ACP. It has lighter recoil and greater magazine capacity than the 45 ACP and is more powerful than the 9mm. Accuracy in most handguns is superb, especially with Bullseye, Winchester 231 and Accurate Arms No. 5.

This cartridge headspaces from the mouth and therefore case trimming must be uniform and accurate. Do not reduce

cases below the trim-to length. Additionally do not roll crimp bullets as this will prevent the case from properly headspacing on its mouth. A modest taper crimp may be employed if found necessary.

It is important not to seat bullets to a shorter length than listed in any handgun cartridge; but especially so in this one. Pressures can be raised dramatically with deep seating.

Test Components:

CasesWinchester
Trim-to Length845"
PrimersWinchester WSP
Primer Size Small Pistol
Lyman Shell HolderNo. 15
Jacketed Bullets Used ... Nosler JHP #44838, 135 gr.
Sierra JHP #8430, 150 gr.
Winchester Silvertip #SHP40, 155 gr.
Speer TMJ #4410, 165 gr.
Winchester Silvertip #SHP10, 175 gr.
Sierra JHP #8460, 180 gr.
Sierra FPJ #8480, 190 gr.
Cast Bullets Used(sized to .401" dia)
#401654, 150 gr.
#401043, 175 gr.
#401638, 175 gr.

Test Specifications:

(Velocity & Pressure)

Firearm UsedUniversal Receiver
Barrel Length4"
Twist1-16"
Groove Dia.401"

135 gr. Jacketed HP						
1.085" OAL						
BC: .093 SD: .121						
Powder	Sugg Starting Grains	Velocity fps	Pressure C.U.P.	Max Load Grains	Velocity fps	Pressure C.U.P.
Bullseye	5.5	1070	19,600	6.3	1203	23,200
AA#2	5.0	1014	19,300	6.0	1168	23,500
231	5.5	1005	17,800	6.7	1185	23,300
Unique	5.8	1025	18,500	6.8	1198	23,000
AA#5	7.2	1026	17,500	8.3	1221	23,500
Power Pistol	7.3	1027	19,200	8.2	1225	23,200
N340	6.3	1020	19,300	7.0	1193	23,000
HS-6	8.0	1022	17,600	9.0	1171	22,000
Blue Dot	9.0	1058	19,500	10.3	1162	23,100

150 gr. Jacketed HP						
1.100" OAL						
BC: .130 SD: .134						
Powder	Sugg Starting Grains	Velocity fps	Pressure C.U.P.	Max Load Grains	Velocity fps	Pressure C.U.P.
Clays	3.5	858	17,100	4.4	1025	21,600
Bullseye	4.9	740	18,200	5.7	890	22,500
231	5.0	799	17,900	6.2	1054	22,800
Unique	5.5	982	17,800	6.6	1132	23,300
AA#5	6.9	998	18,400	7.7	1101	23,300
WST	5.5	968	19,100	6.4	1096	23,400
Power Pistol	6.7	954	19,000	7.5	1105	22,300
N340	5.7	922	18,800	6.3	1091	23,100
HS-6	7.6	990	17,100	8.6	1093	22,300
800X	6.9	999	18,500	8.4	1109	23,200
Blue Dot	8.6	999	18,800	10.0	1140	23,100

Note: Loads shown in shaded panels are maximum.
Loads shown in bold designate potentially most accurate load.

40 Smith & Wesson



155 gr. Jacketed Silvertip
1.125" OAL

BC: .166
SD: .138

Powder	Sugg Starting Grains	Velocity fps	Pressure C.U.P.	Max Load Grains	Velocity fps	Pressure C.U.P.
Bullseye	5.1	771	19,500	5.7	885	22,500
231	5.3	877	18,000	5.9	1053	22,300
Unique	5.8	847	18,300	6.5	1011	22,800
AA#5	7.1	916	18,400	8.0	1054	22,500
Power Pistol	7.0	942	20,400	7.8	1082	23,300
N340	5.5	893	19,800	6.2	993	22,600
HS-6	7.6	924	18,900	8.5	1089	22,800
800X	7.2	988	19,800	8.0	1056	22,400
Blue Dot	8.2	881	18,800	9.2	1010	22,100



165 gr. TMJ
1.120" OAL

BC: .135
SD: .147

Powder	Sugg Starting Grains	Velocity fps	Pressure C.U.P.	Max Load Grains	Velocity fps	Pressure C.U.P.
Bullseye	4.8	733	19,200	5.4	825	22,600
231	5.2	937	19,300	5.8	1050	22,100
Unique	5.4	952	19,300	6.0	1034	21,700
AA#5	6.9	934	18,400	7.6	1025	21,400
Power Pistol	6.3	855	17,900	7.0	953	22,000
N340	5.5	873	18,700	6.1	997	23,000
HS-6	7.6	833	17,400	8.5	979	22,600
800X	7.2	891	19,700	8.0+	1004	22,600
Blue Dot	8.3	922	19,900	9.2	1018	22,400



175 gr. Jacketed Silvertip
1.125" OAL

BC: .142
SD: .156

Powder	Sugg Starting Grains	Velocity fps	Pressure C.U.P.	Max Load Grains	Velocity fps	Pressure C.U.P.
Bullseye	4.7	735	20,000	5.3	843	23,400
WST	5.1	880	19,800	5.7	991	22,800
231	5.1	864	19,900	5.7	983	22,500
Universal	4.9	889	19,400	5.5	973	21,800
Unique	5.3	932	19,500	5.9	1044	23,000
Power Pistol	6.0	844	18,900	6.7	981	22,200
N340	5.4	891	20,600	6.0	1004	23,000
WSF	5.8	930	20,700	6.5	1001	22,500
HS-6	6.9	843	18,000	7.7	970	22,500
800X	6.8	887	20,200	7.6	975	22,900
Blue Dot	7.9	952	19,500	8.8	1057	22,400



180 gr. Jacketed HP
1.115" OAL

BC: .170
SD: .161

Powder	Sugg Starting Grains	Velocity fps	Pressure C.U.P.	Max Load Grains	Velocity fps	Pressure C.U.P.
Clays	3.4	551	17,900	4.0	912	21,900
Bullseye	4.9	628	18,200	5.6	844	23,500
231	5.0	927	20,400	5.6	1015	22,800
Universal	4.8	815	18,500	5.5	941	22,800
Unique	4.9	839	18,800	5.6	916	23,100
Power Pistol	6.0	876	19,300	6.7	974	22,900
N340	5.4	904	20,800	6.0	1014	23,100
WSF	5.0	853	17,700	6.2	993	23,400
HS-6	6.9	860	19,600	8.0	1048	23,500
800X	5.9	906	18,700	7.4	1013	23,400
Blue Dot	7.3	754	18,000	8.8	990	23,300



190 gr. Jacketed FP
1.135" OAL

BC: .190
SD: .170

Powder	Sugg Starting Grains	Velocity fps	Pressure C.U.P.	Max Load Grains	Velocity fps	Pressure C.U.P.
Bullseye	3.9	520	16,200	5.0	722	23,100
231	4.2	540	16,800	5.3	723	23,200
Universal	4.7	730	14,600	5.3	846	23,000
Unique	4.5	535	15,900	5.3	720	23,100
Power Pistol	5.9	720	19,900	6.5	816	23,000
AA#5	5.5	545	16,000	6.5	745	23,200
N340	5.0	773	18,900	5.6	870	23,200
WSF	4.9	530	16,100	5.8	702	22,700
HS-6	6.4	594	16,200	7.2	734	22,300
800X	5.2	573	17,200	6.3	737	22,200
Blue Dot	6.7	567	16,800	8.1	724	22,600



#401654
150 gr. (#2 Alloy) 1.090" OAL

BC: .074
SD: .133

Powder	Sugg Starting Grains	Velocity fps	Pressure C.U.P.	Max Load Grains	Velocity fps	Pressure C.U.P.
Bullseye	5.0	1056	18,600	6.0	1202	23,100
231	5.5	1079	19,000	6.5	1195	22,500
AA#2	5.0	1041	18,600	6.4	1192	22,900
Unique	5.0	980	16,200	6.3	1196	23,000
Power Pistol	6.3	971	18,700	7.0	1112	23,300
AA#5	6.3	969	16,200	7.5	1195	23,500
N340	5.3	911	17,800	5.9	1057	22,500
HS-6	7.5	1038	18,000	8.8	1224	23,500
800X	6.8	1085	19,800	8.0	1180	23,300
Blue Dot	8.3	1033	18,400	9.6	1171	22,800

Note: Loads shown in shaded panels are maximum.
Loads shown in bold designate potentially most accurate load.
+ Designates a compressed powder charge.

40 Smith & Wesson



#401043

175 gr. (#2 Alloy) 1.125" OAL

BC: .098
SD: .155

Powder	Sugg Starting Grains	Velocity fps	Pressure C.U.P.	Max Load Grains	Velocity fps	Pressure C.U.P.
Bullseye	4.2	665	17,100	5.1	812	22,000
231	4.3	863	15,400	5.8	977	22,500
Universal	4.8	832	15,300	5.5	1006	21,900
Unique	4.8	911	15,900	5.8	1023	23,300
Power Pistol	5.9	908	18,900	6.6	998	21,600
AA#5	6.1	903	19,300	6.9	1066	23,000
N340	5.2	918	18,700	5.8	1038	23,000
HS-6	7.0	940	17,000	8.2	1047	23,300
800X	5.6	853	16,500	7.4	974	22,400
Blue Dot	7.3	897	17,900	9.0	1123	23,500



#401638

175 gr. (#2 Alloy) 1.100" OAL

BC: .088
SD: .155

Powder	Sugg Starting Grains	Velocity fps	Pressure C.U.P.	Max Load Grains	Velocity fps	Pressure C.U.P.
Clays	3.3	641	17,800	4.0	992	20,900
Bullseye	4.0	654	16,900	5.0	842	23,100
231	4.3	796	16,000	5.8	970	22,700
Universal	4.7	871	17,400	5.4	1009	22,900
Unique	4.7	898	18,600	5.8	971	23,200
Power Pistol	5.8	873	18,900	6.5	996	22,900
AA#5	6.0	844	18,600	6.9	1047	22,600
N340	4.8	873	18,800	5.4	1008	22,400
HS-6	7.0	976	18,600	8.4	1129	22,800
800X	5.8	878	17,000	7.6	996	22,900
Blue Dot	6.9	979	18,100	8.6	1059	23,200

Note: Loads shown in shaded panels are maximum.
Loads shown in bold designate potentially most accurate load.